

Flux Prevention

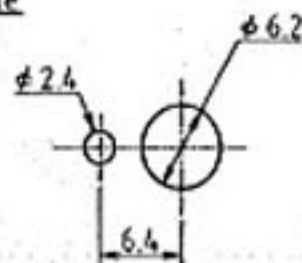

Mtg. Hole Dia (S=2/1)
Tolerances ± 0.1

Symbol	Date	Correct	Approved	Drawn

Specification	
Rating	6A.125VAC
Circuit	SPST (ON-OFF-ON)
Contact Resistance	20m Ω or less, initial characteristics.
Insulation Resistance	500V DC Megger, 10M Ω or more.
Voltage Breakdown	1000V AC (Between terminals) 1500V AC (Between live metal parts and lead metal parts) 50/60Hz for 1 minute.
Durability	Rated load with Resistance, 5,000 cycles, Non-load, 30,000 cycles.

Construction			
13			
12			
11			
10			
9	Common Terminal	Copper	1 Silver Plated
8	Terminal	Silver-plated copper	2 Silver Plated
7	Body	White Phenolic Resin	1 Blue
6	Frame	Stainless Steel	1 Cleaning
5	Locking Ring	Steel	1 Unichromate
4	Lock Washer	Steel	1 Unichromate
3	Hex Nut	Steel	2 Nickel Plated
2	Metal	Brass	1 Nickel Plated
1	Lever	Brass	1 Chrome Plated
Sn.	Part No.	Material	Qty. Finish

Designed date	Checked J. Tsujimura date December.16.1997
Drawn K. Endoh date December.16.1997	Approved S. Tsujimura date '97. Dec. 17

Name	MS-500E-B Toggle Switch
Plan No.	MSS00E-B-J11
Scale= 1/1	All dimensions in millimeters Unless otherwise specified tolerances ± 0.5